

TWIZLA®

INSTALLATION INSTRUCTIONS

WARNING

DO NOT ATTEMPT TO INSTALL OR USE THE TWIZLA® BEFORE READING THE FOLLOWING.

Twizla® Units and Parts are not to be used for horseplay. Use caution when setting up & installing the Twizla®. If you are confused by these instructions or have questions regarding installation of the Twizla® Standard, please contact Above All Advertising, Inc. IMPORTANT: Always wear protective goggles and gloves when handling and installing the Twizla!

Rev 10.29.10

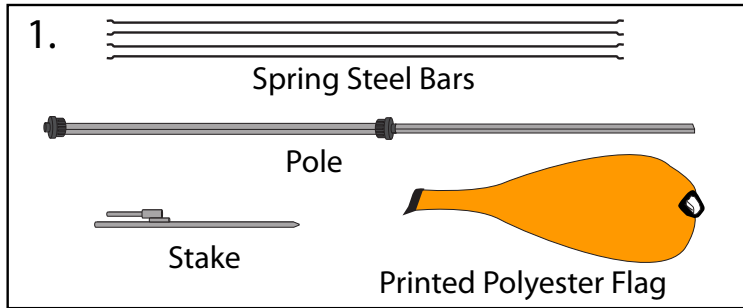

Remove the pieces of the Twizla from carrying case careful to keep the flag from getting dirty.

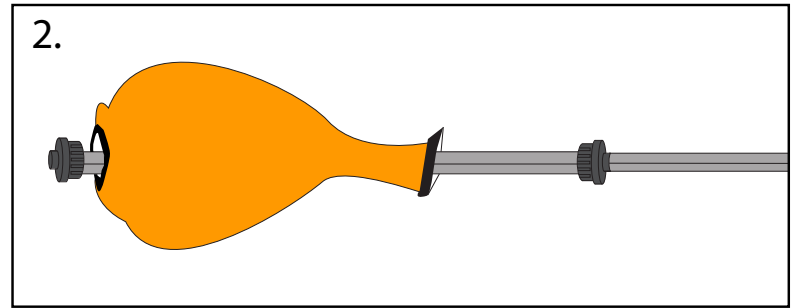

Fit the flag around the pole keeping the zipper towards the bottom of the pole and the pull tie to the top of the pole.

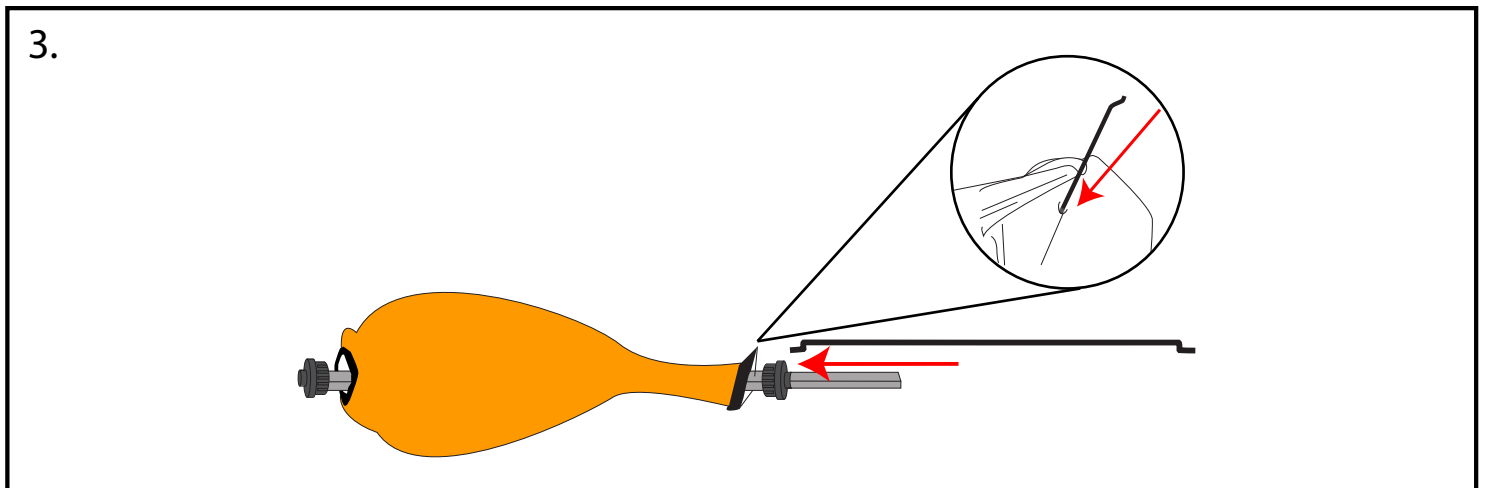

Fit a spring steel bar into the flag careful along the seam inside flag and into the pocket. Then push the spring steel bar gently through the model taking care not to pierce the flag with the spring steel bar. The spring steel bar should poke through the other side of the pocket and out of the flag.

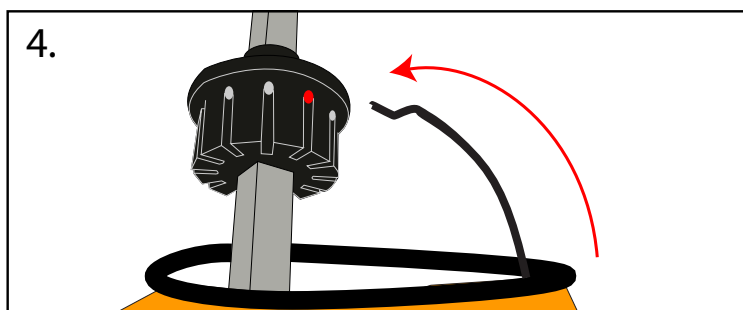

Fit the spring steel bar firmly into the black plastic molding cap keeping the line straight as it is inserted into the hole.

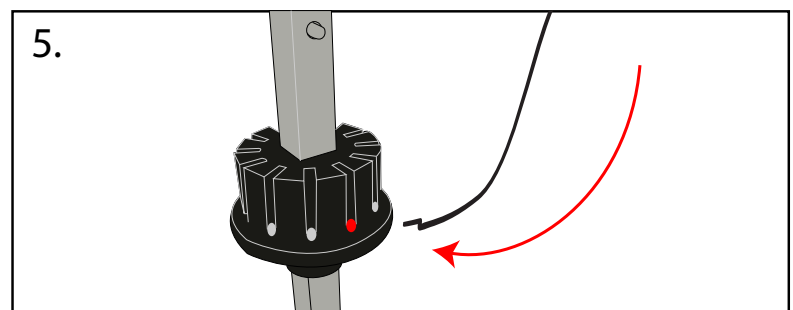

Fit the spring steel bar firmly into the black plastic molding cap keeping the bar straight as it is inserted into the hole. The spring steel bar should be directly in line with the top hole.

6. Repeat steps three to five for each side of the Twizla. Making sure each spring steel bar is firmly held by the black plastic molding cap. Take care not to bend the spring steel bar beyond it's limit and use protective eyeware and gloves when assembling the Twizla.